

EVENTS HALLS

SPACE TO IGNITE YOUR IMAGINATION

The impressive ADNEC Centre Al Ain features a unique architectural design that can offer premium space with maximum flexibility, each hall can be customised to meet the needs and requirements of organisers to deliver a truly memorable experience.



ADNEC Centre Al Ain

In numbers:

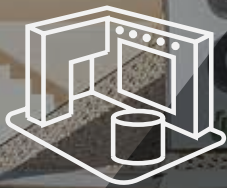

20,000^{SQM}
TOTAL SPACE



7
MID-RANGE
CONFERENCE
AND MEETING
ROOMS



242
DELEGATES
AUDITORIUM
WITH TIERED
SITTING



+11,000
DELEGATES
CONFERENCE
SCALE



2
EVENT HALLS
AND LINK AREA



812
PARKING SPACE

ADNEC
VENUES

ADNEC
EVENTS

ADNEC
HOTELS

ADNEC
F&B

ADNEC
SERVICES

ADNEC
TOURISM

ADNEC
MEDIA

AL KHABISI HALL 1

Hall	Dimension (m)	Floor Area (sq.m)
Al Khabisi Hall 1	59.40m x 109.40m	6,498

Banquet	Cabaret	Classroom	Theatre
2,000	1,664	2,760	5,646

Ceiling height	10.30 m
Entrances	4
Loading Doors (1.1 , 1.3)	Width 4m x Height 4.2m

ACCESS

- Conference and meeting rooms facilities
- Auditorium
- Al Barza
- Link area
- Gates 1,2,3 & 4

CONFIGURATIONS

Multiple configuration are available depending on your requirement, Al Khabisi Hall 1 can easily be sectioned into 2 individual spaces.

SUPPORT SERVICES

- Dedicated planning manager
- AV services
- Free Wi-Fi available

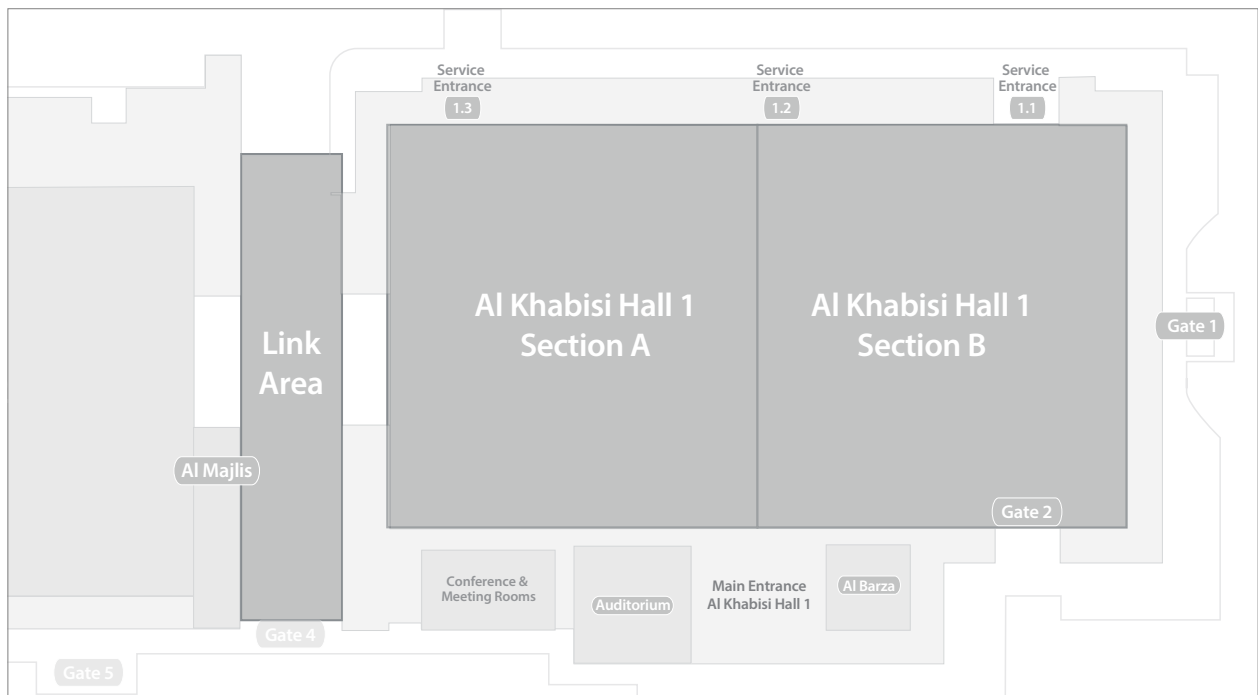

AL KHABISI HALL 2

Hall	Dimension (m)	Floor Area (sq.m)
Al Khabisi Hall 2	59.40m x 89.40m	5,310

Banquet	Cabaret	Classroom	Theatre
1,600	1,392	2,508	4,660

Ceiling height	10.30 m
Entrances	4
Loading Doors (2.1 , 2.3)	Width 4m x Height 3.6m

ACCESS

- Link area
- Al Majlis
- Gates 4,5,6 & 7

CONFIGURATIONS

Multiple configurations are available depending on your requirement, Al Khabisi Hall 2 can easily be sectioned into 2 individual spaces.

SUPPORT SERVICES

- Dedicated planning manager
- AV services
- Free Wi-Fi available

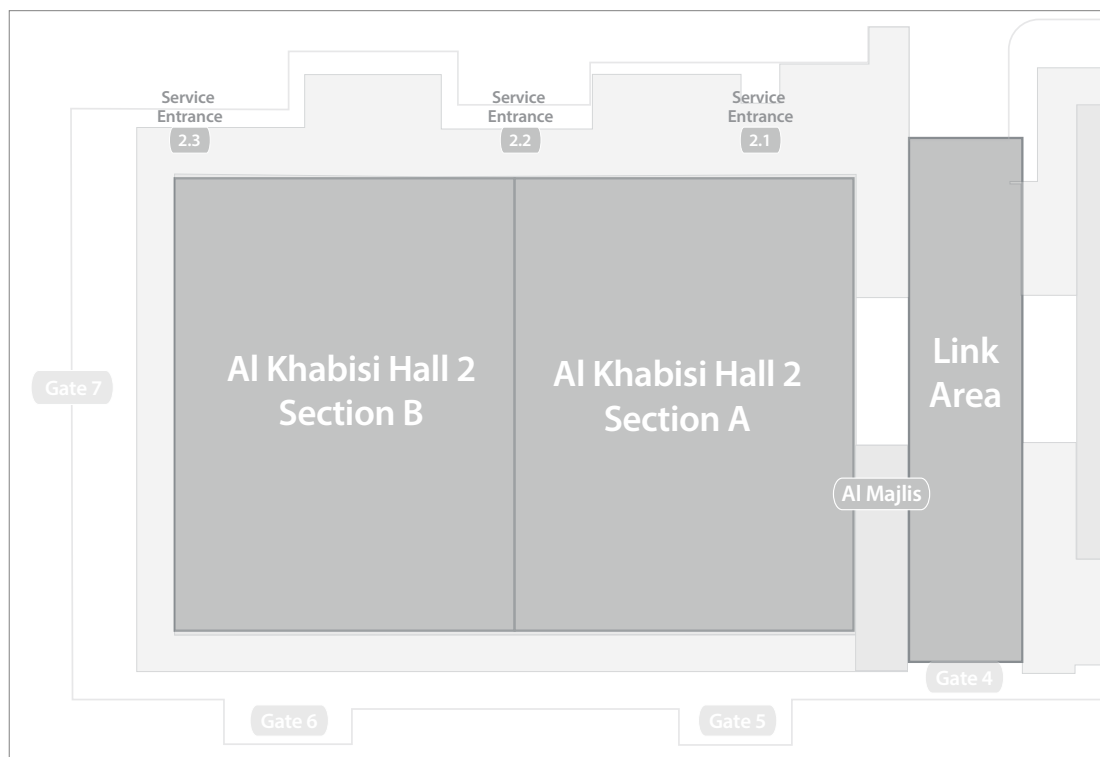

LINK AREA

THE HUB THAT KEEPS YOU CONNECTED



Connecting Halls 1 and 2, The Link area is usually used as the reception area during exhibitions and conferences. The space is also utilised as a dining area during events. It has two entrances that are easily accessed.

Total Area	1,114 sqm
Ceiling height	5.97 m

ACCESS

- Al Khabisi hall 1
- Al Khabisi hall 2
- Conference and meeting rooms facilities
- Main entrance Gate 4

SPECIAL FEATURES

- Connecting Al Khabisi Hall 1 and Al Khabisi Hall 2
- Two digital screens
- Natural daylight

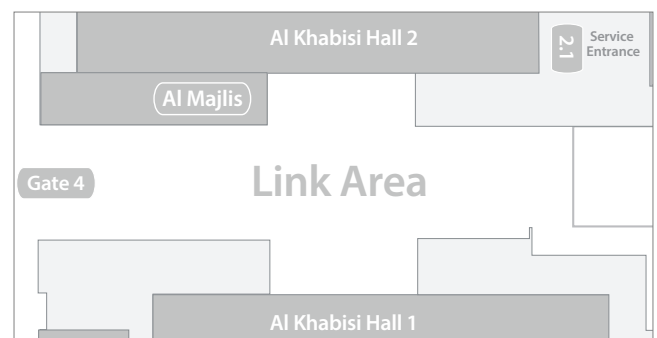

SUPPORT SERVICES

- Dedicated planning manager
- AV services
- Free Wi-Fi Available

CONFERENCE AND MEETING ROOM FACILITIES

ELEVATE YOUR MEETING EXPERIENCE

Flexibility is at the heart of our Facilities, with its 7 Mid-range of Conference and Meeting Rooms alongside with the Auditorium which has tiered sitting up to 242 delegates.



CONFERENCE ROOMS

FLEXIBILITY IN EVERY FORM

Conference room	Dimension (m)	Floor Area (sqm)
Conference room 1	11.40 x 9.89	112.7
Conference room 2	11.40 x 6.42	73
All rooms (No Partition)	16.40 x 11.40	186.96

Conference room	Banquet	Cabaret	Classroom	Theatre	U-Shape	Board
Conference room 1	50	40	78	108	30	42
Conference room 2	30	24	39	54	18	30
All rooms (No Partition)	80	64	142	197	48	60

ACCESS

- Main entrance - Link Area (Gate4)
- Al Khabisi Hall 1
- Al Khabisi Hall 1 Main entrance (Gate3)

CONFIGURATIONS

Conference rooms can be divided into 2 separate areas to host multiple events depending on your needs.

SPECIAL FEATURES

- Built-in Projector and Retractable Screen
- LED TV Screens
- Built-in Sound System and microphone
- Natural daylight

SUPPORT SERVICES

- Dedicated planning manager
- AV services
- Free Wi-Fi Available

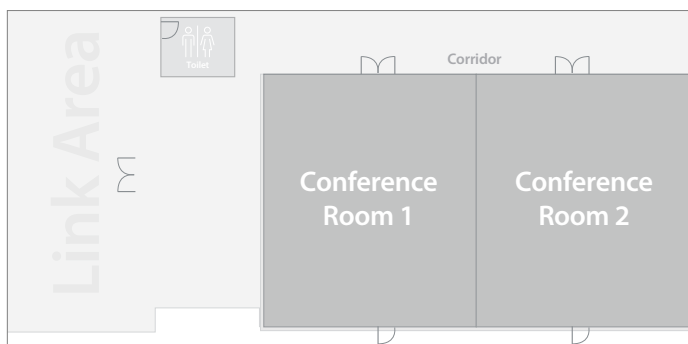

MEETING ROOMS

CONTEMPORARY SPACES DESIGNED FOR MEETINGS

Conference room	Dimension (m)	Floor Area (sqm)
Meeting room 1	7.38 x 5.52	40.7
Meeting room 2	7.38 x 5.42	40
Meeting room 3	7.38 x 5.38	39.7
All rooms (No Partition)	16.52 x 7.38	121.91

Capacity	Banquet	Cabaret	Classroom	Theatre	U-Shape	Board
Meeting room 1	20	16	25	35	15	18
Meeting room 2	20	16	25	35	15	18
Meeting room 3	20	16	25	35	15	18
All rooms (No Partition)	60	48	84	132	42	48

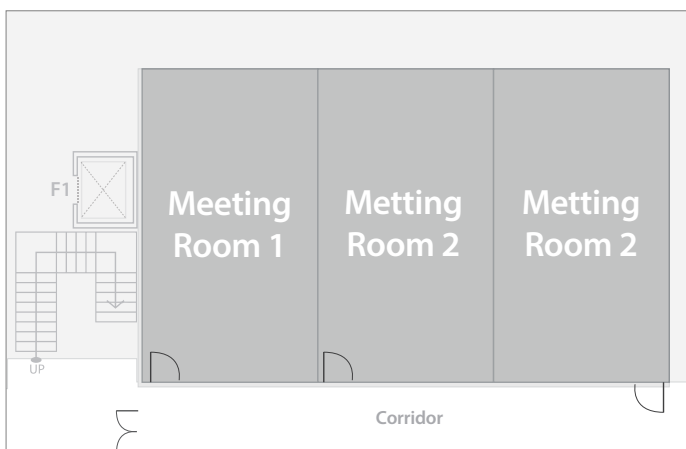

ACCESS

Main entrance - Link Area (Gate4)

CONFIGURATIONS

The three Meeting rooms can be interconnected to host bigger events depending on your needs.

SPECIAL FEATURES

- Built-in Projector and Retractable Screen
- LED TV Screens
- Natural daylight

SUPPORT SERVICES

- Dedicated planning manager
- AV services
- Free Wi-Fi Available



AUDITORIUM

THE LATEST TECHNOLOGY IN A COMFORTABLE SETTING



Max capacity	242 delegates
Ceiling height	6.65 m
Entrances	2
Door dimentions	H 1.92m x W 2.13m

ACCESS

- Al Khabisi Hall 1 Main entrance (Gate3)
- Al Khabisi Hall 1
- Conference and Meeting rooms facilities

SPECIAL FEATURES

- Built in stage and audio-visual suite
- Built-in Projector and Retractable Screen
- Built-in Sound System and microphone
- Fully furnished auditorium with tiered sitting

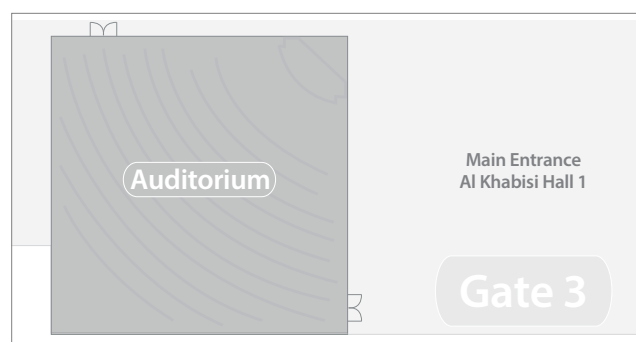

SUPPORT SERVICES

- Dedicated planning manager
- AV services
- Free Wi-Fi Available

AL BARZA

A VIP LUXURY ROOM

Area	Dimension (m)	Floor Area (sqm)
Al Barza	12.15 x 12.15	147.6

Majlis	Banquet	Cabaret	Classroom	Theatre	U-Shape	Board
47	60	48	75	144	36	48

ACCESS

- Al Khabisi Hall 1 Main entrance (Gate3)
- Al Khabisi Hall 1
- Conference and Meeting rooms facilities

SUPPORT SERVICES

- Dedicated planning manager
- AV services
- Free Wi-Fi Available

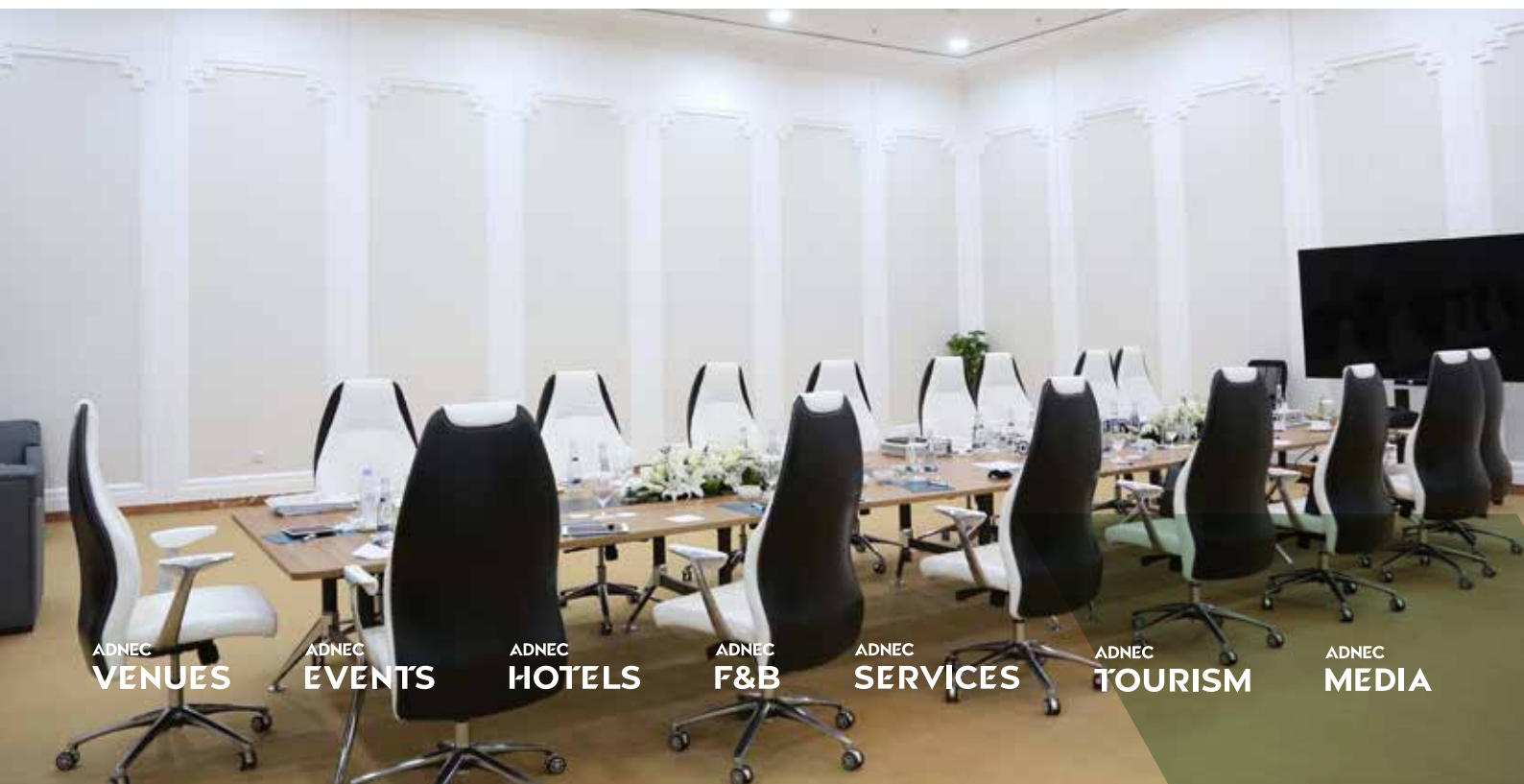
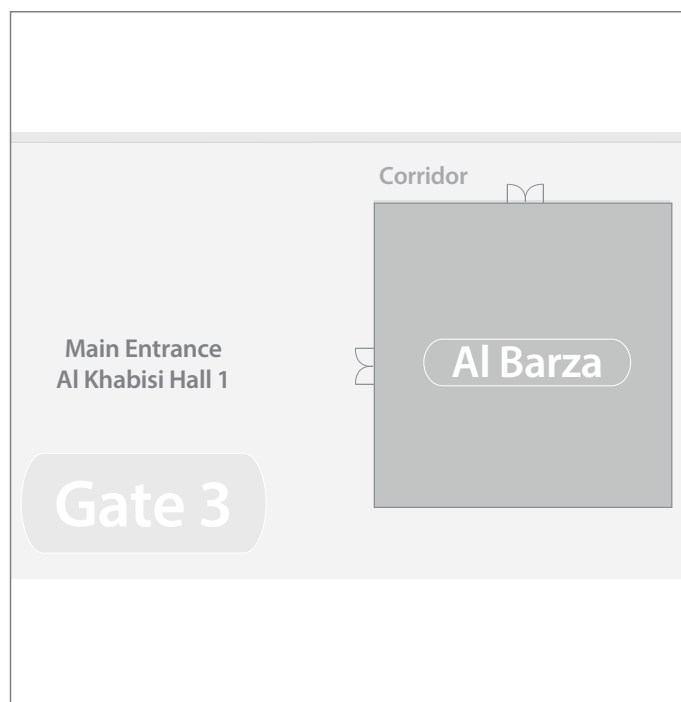

ADNEC
VENUES

ADNEC
EVENTS

ADNEC
HOTELS

ADNEC
F&B

ADNEC
SERVICES

ADNEC
TOURISM

ADNEC
MEDIA

AL MAJLIS

VIP SPACES FOR MEETINGS AND EVENTS

Area	Dimension (m)	Floor Area (sqm)
Al Majlis	9.75 x 6.80	64.9

Majlis	Banquet	Cabaret	Classroom	Theatre	Board
25	20	16	24	48	24

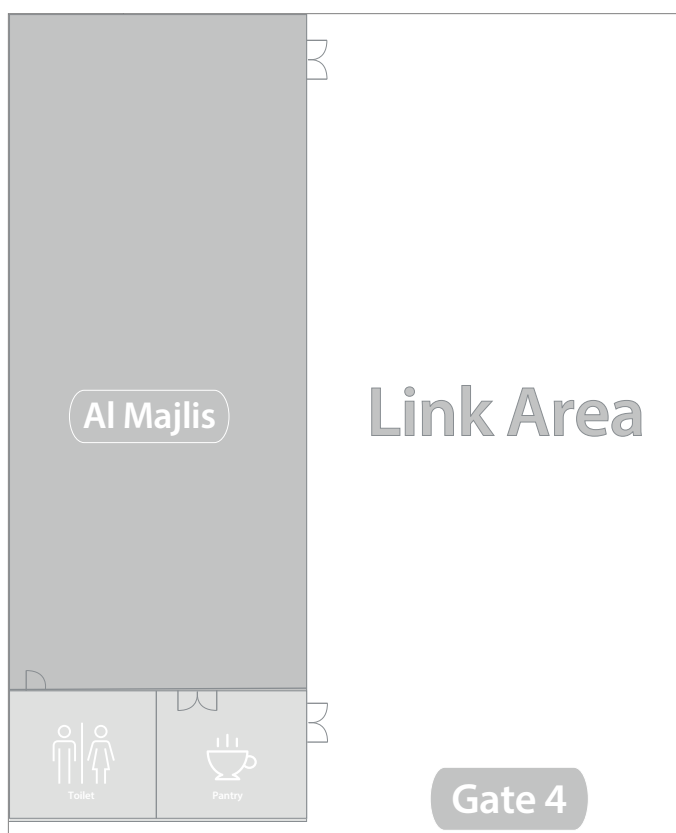

ACCESS

- Main entrance - Link Area (Gate4)
- Al Khabisi Hall 2
- Conference and Meeting rooms facilities

SPECIAL FEATURES

- Built-in LED TV Screen
- Private Pantry
- Adjacent Toilet

SUPPORT SERVICES

- Dedicated planning manager
- AV services
- Free Wi-Fi Available

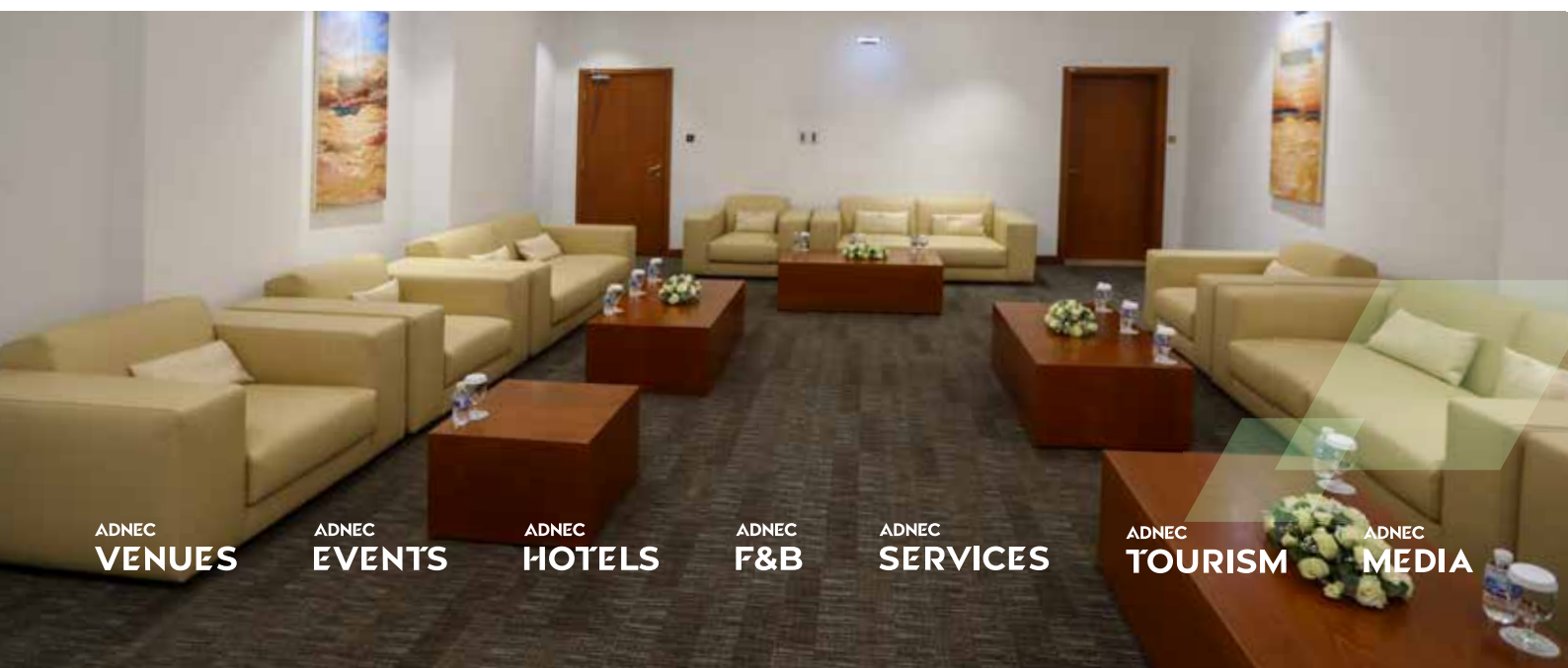

ADNEC
VENUES

ADNEC
EVENTS

ADNEC
HOTELS

ADNEC
F&B

ADNEC
SERVICES

ADNEC
TOURISM

ADNEC
MEDIA

